



**RURAL MUNICIPALITY OF DUFFERIN
PUBLIC NOTICE
REGARDING THE PR ROAD RESERVE EXPENDITURE**

PUBLIC NOTICE is hereby given pursuant to subsection 169(8) of The Municipal Act that the Council of the Rural Municipality of Dufferin intends to transfer PR Road Reserve funds in the amount of \$50,902.17 to the Operating Fund.

These funds will be used for road reconstruction purposes.

Council will hear any person who wishes to make a presentation, ask questions, or register an objection to the proposed transfer at:

**Rural Municipality of Dufferin
Memorial Hall, 12-2nd Ave SW, Carman, MB
Tuesday, April 7th, 2026 7:00 p.m.**

Copies of the proposed expenditure may be examined during regular office hours at the Rural Municipality of Dufferin office, 12-2nd Avenue S.W., Carman.

Dated at the Rural Municipality of Dufferin the 27th day of February, A.D. 2026.

**Sharla Murray, CMMA
Chief Administrative Officer
Rural Municipality of Dufferin**

RURAL MUNICIPALITY OF DUFFERIN

PR Road Reserve Expenditure Plan (2026)

What is being proposed?

The RM of Dufferin is proposing to use **\$50,902.17 from the PR Road Reserve Fund** to support road reconstruction work at various Roads throughout the Municipality.

What work will be done?

- Reconstructing and gravelling approximately **12.5 miles of road**
 - Applying gravel at about **450 cubic yards per mile**
 - Improving road surface, crown, and drainage where needed
-

Why is this work needed?

This work goes beyond regular maintenance and is intended to:

- Improve road conditions and safety
 - Address wear, rutting, and base issues
 - Reduce future maintenance costs
-

How will the work be completed?

- The RM will use **its own equipment and staff where possible**
 - Some **materials and hauling may be contracted** as needed
 - Work will focus on the areas shown on the attached map
-

How is this funded?

- **\$50,902.17** from the PR Road Reserve Fund
 - Additional value is provided through **municipal labour and equipment**
-

Is this allowed?

Yes. The PR Road Reserve was created under **By-law No. 1947** for the maintenance and construction of various Roads throughout the Municipality.

Public Input

Council will hear from anyone who wishes to speak, ask questions, or make a presentation at the public hearing.

Summary

This project will improve approximately **12.5 miles of various Roads throughout the Municipality** using a combination of reserve funds and municipal resources, helping extend the life of the road and improve driving conditions.

Schedule "A"

MUN. OF DUFFERIN

PROVINCE OF MANITOBA
HIGHWAYS DEPARTMENT
DESIGN OFFICE
WPG., OCT., 1969



SCALE: 1 in. = 3 miles

REVISED :
OCTOBER 24, 1991

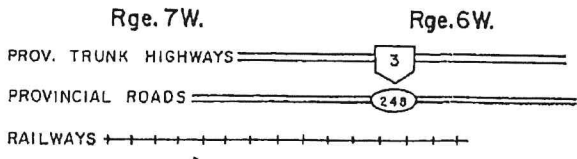
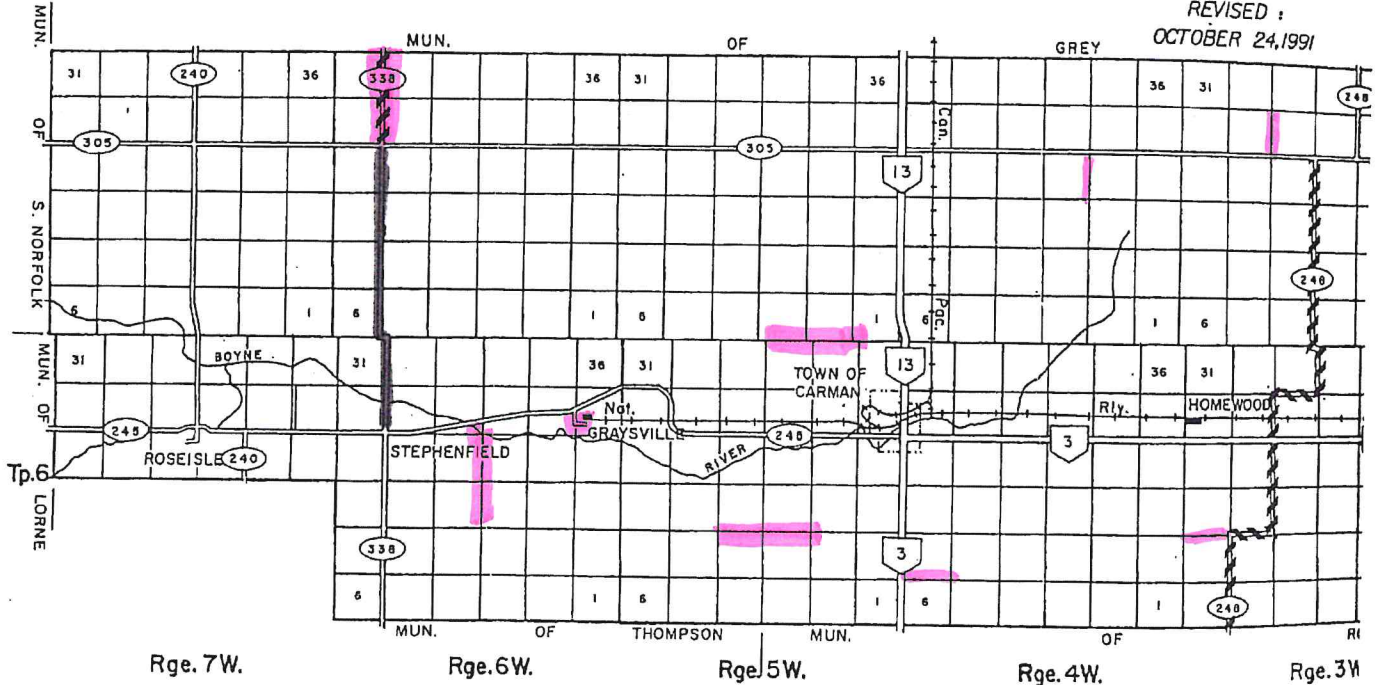



RURAL MUNICIPALITY OF DUFFERIN

By-Law No. 1947

**Being a by-law of the Rural Municipality of Dufferin
amending the existing Provincial Road Reserve.**

WHEREAS subsection 168(1) of The Municipal Act provides as follows:

“A council may by by-Law establish reserve funds for any general or specific purpose”;

AND WHEREAS in 1992 the Province of Manitoba transferred 2 miles of Provincial Road 338 to the Rural Municipality of Dufferin as per the attached map as Schedule “A” north of Provincial Road 305;

AND WHEREAS the balance of \$4,897.43 is remaining to spend on the original 2 miles of Provincial Road 338 north of Provincial Road 305;

AND WHEREAS the Province of Manitoba is transferring 6 miles of Provincial Road 338, with exception to the Provincial Bridge on Road 35W between Sections 30 and 29-6-6 WPM, to the Rural Municipality of Dufferin as per the attached map as Schedule “A” between Provincial Road 305 to Provincial Road 245;

AND WHEREAS the Provincial Government is providing a one-time compensation grant from the Province of Manitoba to the Rural Municipality of Dufferin in the amount of \$49,950.00, being 6 miles of road at \$8,325.00 per mile, and payable as follows:

\$49,950.00 payable March 31, 2015;

AND WHEREAS the Provincial Government is providing a one-time grant from the Province of Manitoba to the Rural Municipality of Dufferin culverts up to the value of \$10,050.00;

AND WHEREAS the Provincial Government is providing a one-time abandonment grant from the Province of Manitoba to the Rural Municipality of Dufferin in the amount of \$28,968.18, being 9.656 kilometers of road at \$3,000.00 per kilometer, and payable as follows:

\$28,968.18 payable prior to September 30, 2016;

AND WHEREAS the Rural Municipality of Dufferin deems it to be in the best interest of the municipality to create a reserve to be referred to as the “Provincial Road Reserve”;

NOW THEREFORE BE IT ENACTED as a by-law of the Rural Municipality of Dufferin;

1. That a Provincial Road Reserve Fund be and hereby is created;
2. That the sum of \$49,950.00 be deposited into the Provincial Road Reserve in the year 2015 and \$28,968.18 be deposited into the Provincial Road Reserve in the year 2016.
3. That the funds in this reserve shall be expended for the maintenance and construction of the Provincial Road 338 transferred as per the attached map and the funds shall be expended as determined by Schedule "B" as attached, which may be amended by resolution of council.
4. That the Rural Municipality of Dufferin shall keep both in its books, a separate account designating the purpose for which the fund was created and showing at all times that state of the Reserve Funds created hereby.
5. That if the reserve fund or any portion thereof is invested; the securities therefrom shall be earmarked and kept separate from other securities of the Rural Municipality of Dufferin.

THAT By-law No. 1629 is hereby repealed.

DONE AND PASSED by the Council of the Rural Municipality of Dufferin, in open session, duly assembled, in Carman, Manitoba this 19th day of May, 2015.



Reeve George Gray

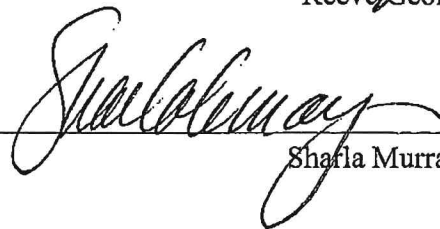

Shafia Murray, CAO

Read a first time this 21st day of April, 2015.

Read a second time this 19th day of May, 2015.

Read a third time this 19th day of May, 2015.

Schedule "A"

MUN. OF DUFFERIN

PROVINCE OF MANITOBA
HIGHWAYS DEPARTMENT
DESIGN OFFICE
WPG, OCT., 1969



SCALE: 1 in. = 3 miles

REVISED
OCTOBER 24, 1991

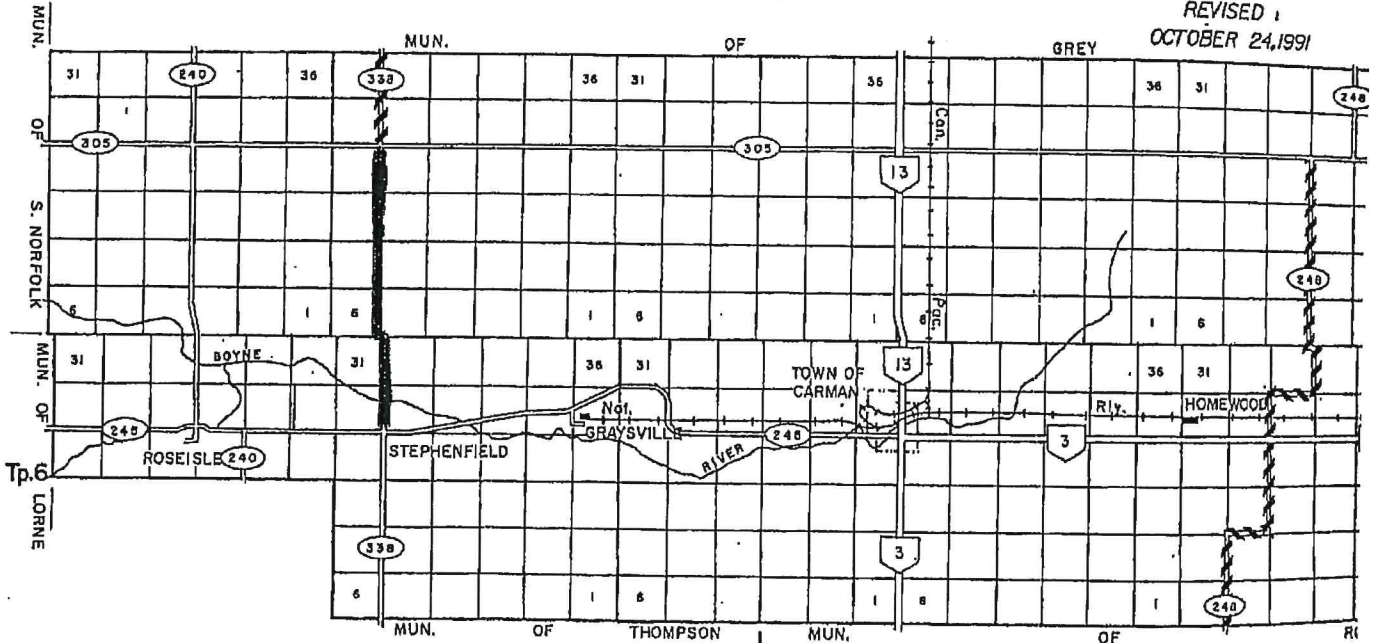

Rge. 7W.

Rge. 6W.

Rge. 5W.

Rge. 4W.

Rge. 3W.



Schedule "B" to By-Law #1947 Provincial Road Reserve

Rural Municipality of Dufferin

Description of the Proposed Maintenance and Construction - the funds in this reserve shall be expended for the maintenance and construction of the Provincial Road 338 transferred as per Schedule "A" between Provincial Road 305 to Provincial Road 245;

- a) **Maintenance on old portion** – to maintain the 2 miles of Road the maintenance gravel would be 160 yards of gravel for each mile to be gravelled every year; E of 33 & 28-6-7 WPM.

- b) **Maintenance on new portion** – to maintain the 6 miles of Road the maintenance gravel would be 200 yards of gravel for each mile to be gravelled every year; E of 30 & 31-6-6 and E of 6, 7, 18 & 19-7-6.

Sharla Murray, CMMA

Chief Administrative Officer

April 21st, 2015